

hp2xi-o VESA adapter

Assembly instructions

This VESA adapter is compatible with the following HP OMEN monitors:

OMEN 25i

WARNING

To minimize the risk of injury, it is important to carefully read all instructions before installation. We accept no liability for personal or material damage caused by improper use of this product. Also, be sure to pay attention to the technical specifications of the product.

1. Read all instructions thoroughly.
2. A faulty installation can lead to damage or serious injury. Ensure that the product and the monitor are securely mounted before use.
3. Make sure that the mount to which the product is attached can easily support the total weight of the monitor, computer, and adapter.



Technical Specifications

- **Maximum monitor weight:** 7 kg / 15.4 lbs
- **VESA standard compatibility:** 75x75 mm
- **Material:** plastic
- **Pivot angle:** compatible (90°)
- **Maximum operating temperature:** 35°C / 95°F
- **Maximum ambient temperature:** 35°C / 95°F

WARNING

Exceeding the maximum load capacity, operating temperature or ambient temperature can lead to serious injury or damage.

Important Safeguards



Please read this manual carefully and keep it for future reference. If you pass the product on to third parties, this manual should always be included. Ignoring these instructions may result in injuries or damage to people and products, for which we cannot accept any liability.

IMPORTANT - FOR FUTURE REFERENCE.

- The use of this product should always be in accordance with the specified safety instructions.
- Do not install your VESA adapter in combination with the monitor in places where people are underneath.
- Do not exceed the maximum weight of the compatible monitor models, as this may result in serious injuries or property damage.
- Pay attention to the maximum ambient temperature of 35°C when using the product.
- Do not mount the VESA adapter near a heat source or in direct sunlight, as this may cause the adapter to overheat.
- Check if your mounting point (e.g., monitor arm) can support the weight of the monitor with the VESA adapter.
- The product is designed exclusively for mounting with a hole pattern of 75x75 mm.
- After installing the VESA adapter, the position of the monitor must be readjusted to ensure proper ergonomics.

WARNING

Ensure that the device is turned off and disconnected from the power supply before installation to avoid possible injuries or damage.

1. Before First Use

Check the product carefully for possible transport damage and for the absence of accessories, such as screws, which should be included in the scope of delivery.

CAUTION

Make sure that packaging materials and small screws and parts contained therein are inaccessible to children to minimize the risk of choking and other risks.

2. Maintenance and Cleaning

2.1 Maintenance

- It is recommended to check every three months that all screws are still tight. Also, regularly check the condition of all components of the product.
- Store the product in a cool and safe place, ideally at a maximum storage temperature of 40°C. For additional safety, keep the product away from children and preferably in its original packaging.
- Avoid any vibrations and shocks so as not to affect the life and functionality of the product.

2.2 Cleaning

- No corrosive or hot cleaning agents should be used to clean the product. Likewise, wire brushes, metal or other sharp materials are unsuitable for cleaning and should not be used.
- For gentle and effective cleaning, the use of a soft, damp cloth is recommended.

3. Waste Disposal

For the disposal of this product we recommend to contact the responsible local authorities or disposal services. They can provide you with detailed information on available disposal options and recycling centers in your area.

4. Manufacturer Information

3idee S.à r.l.
19 Rue de Bitbourg
L-1273 Luxembourg
Luxembourg

mail: info@3idee.eu

5. Help and Feedback

If you need help with your article, we are here for you. We also appreciate any feedback.

<https://help.3idee.eu/en/contact>

Scope of Delivery Accessories

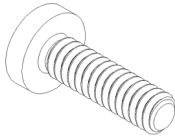

4x M4x14 screw with cross slot
(**SP1**)

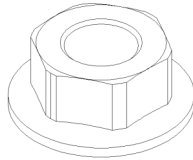

4x M4 lock nut (**SP1**)

⚠ NOTE: Please check before assembly that all accessory parts are complete. If anything is missing, please contact our customer service immediately by email or phone. We are happy to assist you.

Horizontal / Vertical Alignment

⚠ NOTE: Not all VESA adapters and monitors are designed for a vertical (portrait) orientation. This limitation is often due to the specific geometry of the adapter or monitor. Do not ignore this information, as the load limit of the adapter can be quickly exceeded if not mounted properly.

We are continuously working on developing monitors and adapters that are also suitable for vertical orientation.

By default, however, monitors are designed for a horizontal orientation.

**Horizontal
Mounting: YES**



**Vertical
Mounting: YES**

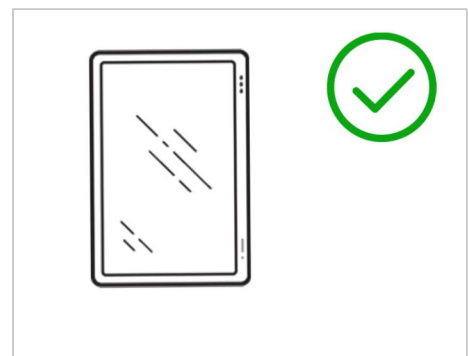

Assembly Instruction

Step 1

Place your HP monitor securely on a soft surface.

Now remove the base of your HP monitor if it is attached.

Step 2

⚠ NOTE: If the instructions provided in this step are not suitable for your device, please follow the manufacturer's mounting guidelines for your monitor arm or swivel arm to attach the monitor to the wall or the swivel arm.

Mount the adapter to the VESA connection of your monitor arm or directly to the wall. (Figure 1)

⚠ NOTE: Make sure to mount the VESA adapter with the **writing facing up**.

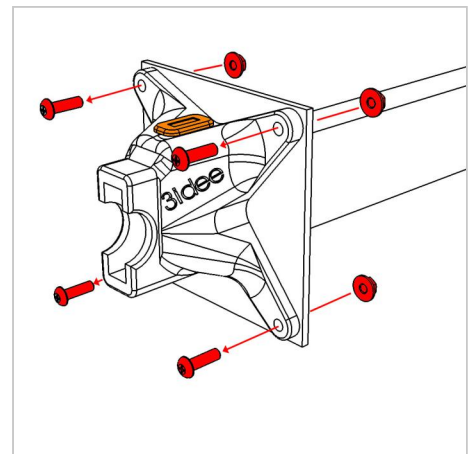

Figure 1

Step 3

The colored clip in the VESA adapter serves as an aid for later removal of the monitor from the VESA adapter (**should this ever be desired**) (Figure 2).

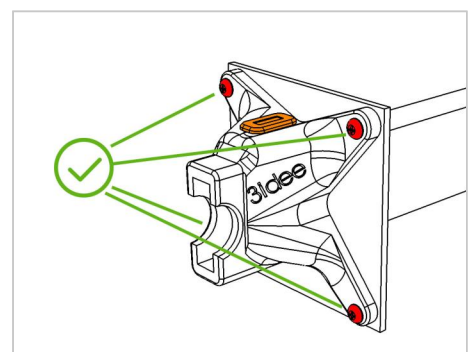

Figure 2

Step 4

Plug the monitor into the adapter until you hear it click into place.

⚠ **NOTE:** If necessary, apply **some** pressure while doing this! (Figure 3)

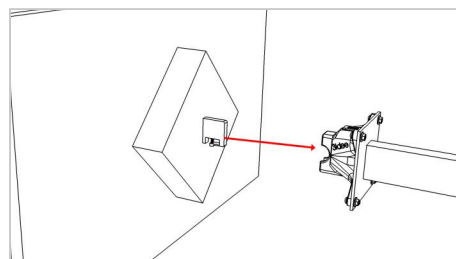

Figure 3

Step 5

Pull a little on your monitor to check if it is properly locked into the VESA adapter. You can check this by looking from below to see if the monitor is locked into the VESA adapter. (Figure 4)

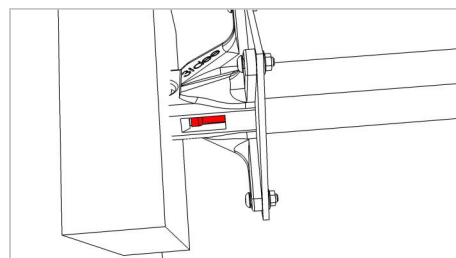

Figure 4